

## STEP 1

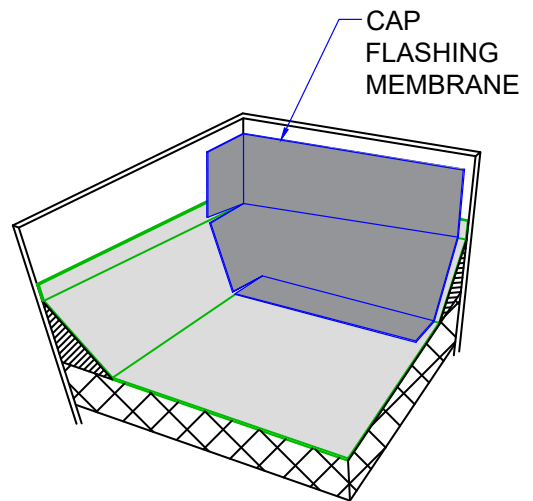

## STEP 2

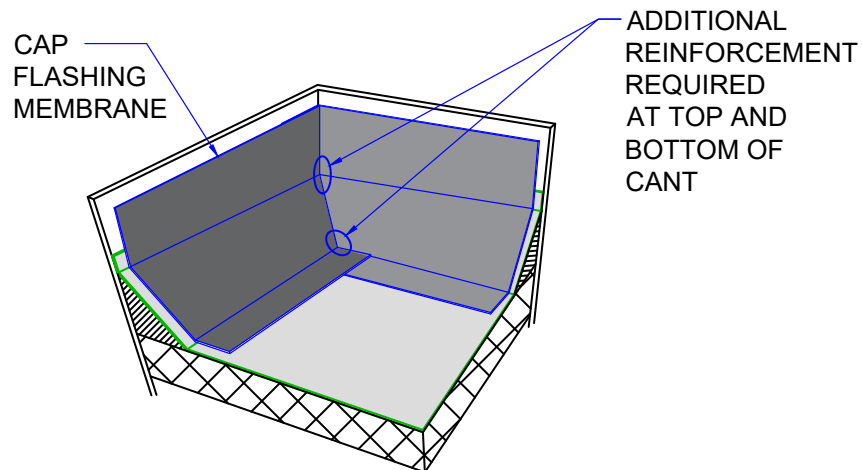

## STEP 3

### GENERAL NOTATIONS:

1. For heat fused membrane applications, set metal flashing onto heated softened membrane.
2. Extension of field base/plies 1" min above top of cant, required(not shown for clarity).
3. Membrane end laps to be a minimum 6" and fully adhered at all membrane to membrane seams.
4. Membrane laps at flanged metal to be 3" minimum and fully bonded to primed metal surface.



[polyglass.us](http://polyglass.us)

1111 West Newport Center Drive  
Deerfield Beach, FL 33442  
Technical Service: (866) 794-9659  
[technical@polyglass.com](mailto:technical@polyglass.com)

### Description:

## INSIDE CORNER FLASHING DETAIL (Typical)

### Number:

PG-LS-WALL-04

### Revision Date:

072023